

HUDSON RIVER-BLACK RIVER REGULATING DISTRICT

BENEFICIARY SITE SURVEY

HISTORY

Parcel No. 24 December 15, 1922 – City of Watertown

All those certain tracts or parcels of real estate situated in the City of Watertown, and the Towns of Pamela and Watertown, County of Jefferson, State of New York, on both sides of the Black River and on Huntington and Delano Islands in the Black River at Huntingtonville, being the water power property owned by the said City of Watertown at the City Water Works, including all water power, water rights, privileges, easements, dams raceways, buildings, and fixtures of every kind appurtenant thereto.

CHANGES: SINCE DECEMBER 15, 1922

There have never been any changes to the Parcel

Map

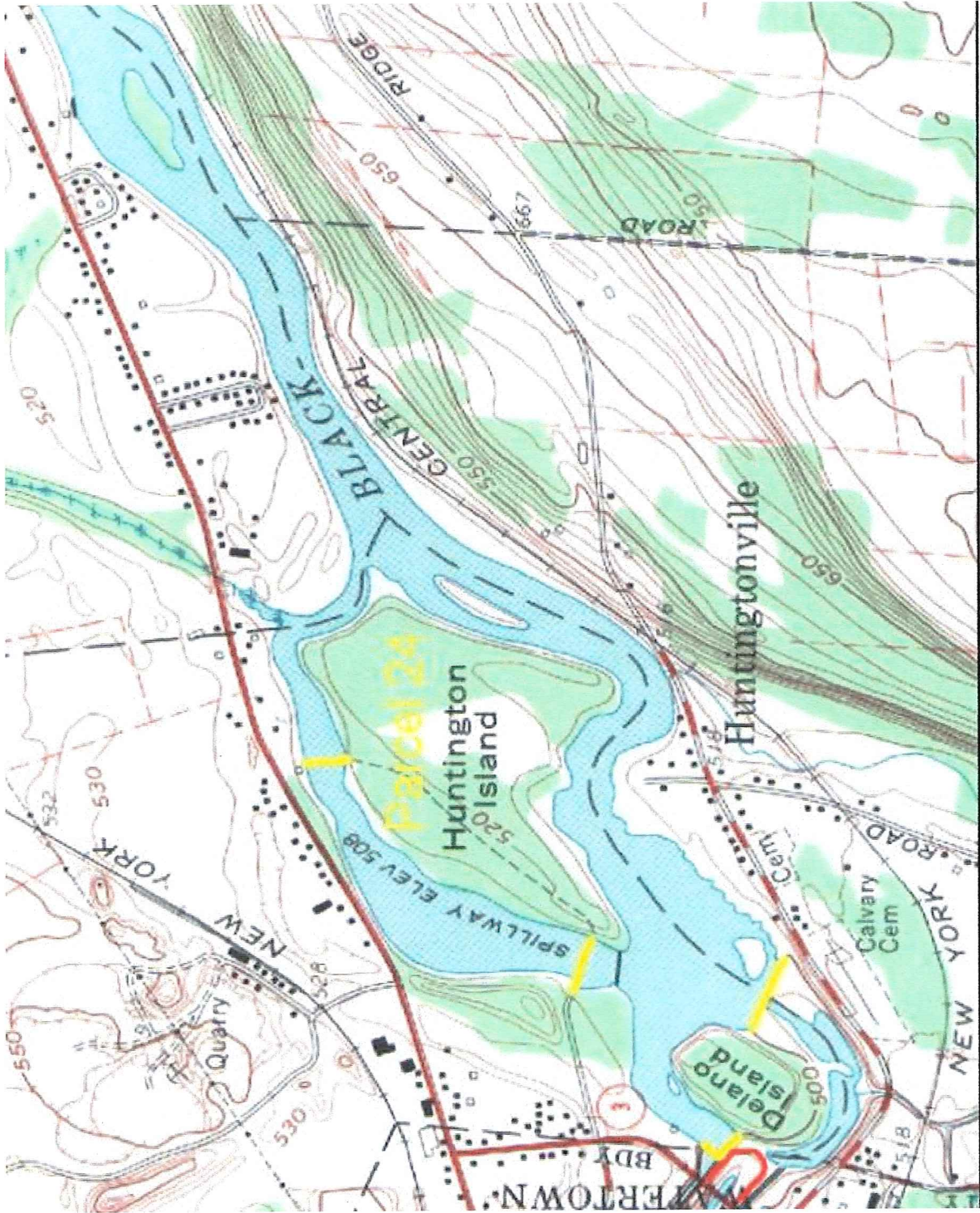

HUDSON RIVER-BLACK RIVER REGULATING DISTRICT

BENEFICIARY SITE SURVEY

HISTORY

Parcel No. 25 December 15, 1922 --- Northern New York Utilities, Inc.

All those certain tracts or parcels of real estate situated in the Village of Black River and the Towns of LeRay and Rutland, County of Jefferson, State of New York, being the water properties owned by the Northern New York Utilities, Inc., known and described as the Lower Black River Power Plant, situated on the northerly side of the Black River in the said Town of LeRay, and the Upper Black River Power Plant, situated on the southerly side of the Black River in the said Village of Black River, including all water power, water rights, privileges, easements, dams raceways, canals, buildings, and fixtures of every kind appurtenant thereto.

CHANGES: SINCE DECEMBER 15, 1922

1938 Changed to Central New York Power Corporation

1951 Changed to Niagara Mohawk Power Corporation

2000 Changed to Erie Boulevard Hydropower, L.P.

Map

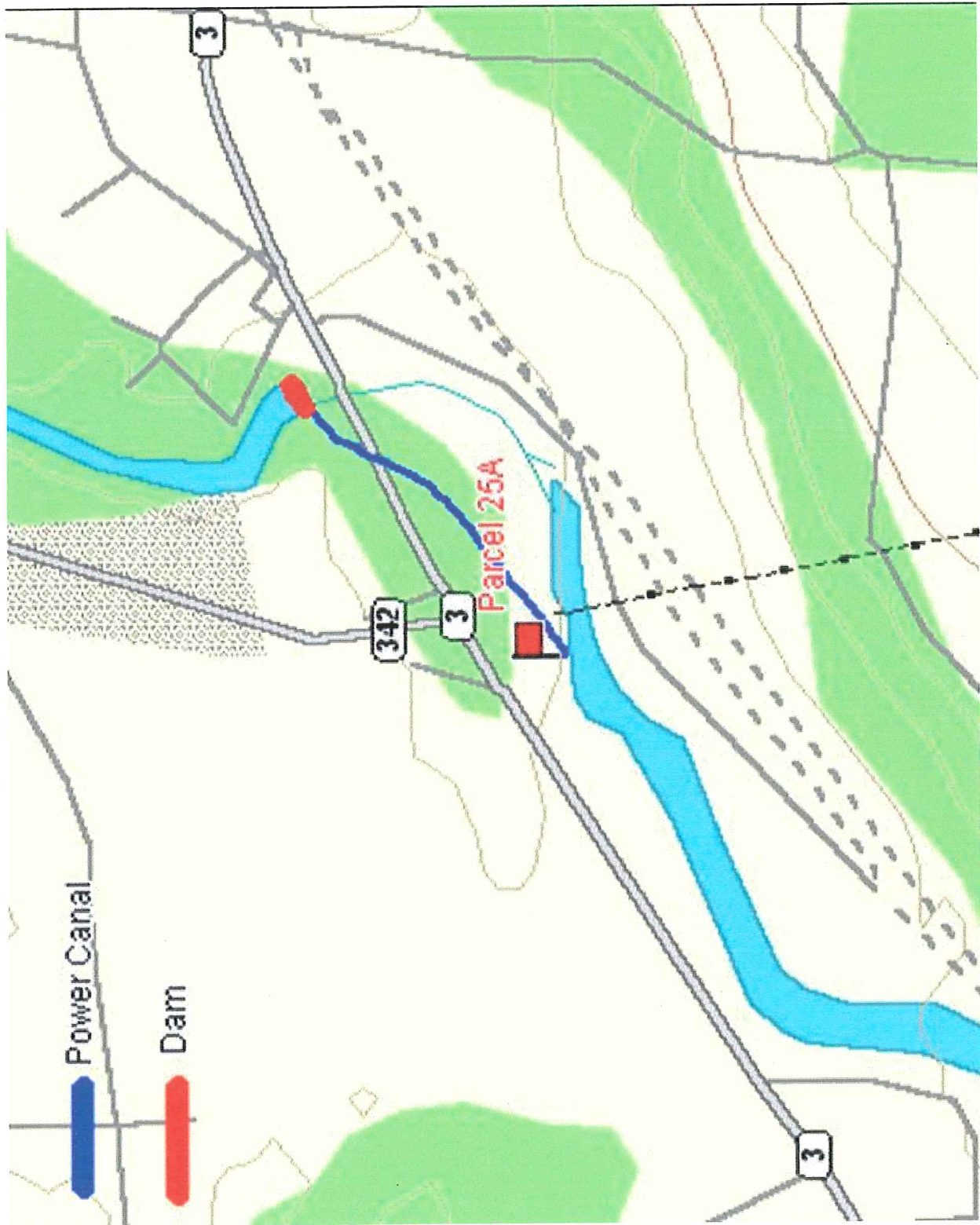

HUDSON RIVER-BLACK RIVER REGULATING DISTRICT

BENEFICIARY SITE SURVEY

HISTORY

Parcel No. 25 December 15, 1922 --- Northern New York Utilities, Inc.

All those certain tracts or parcels of real estate situated in the Village of Black River and the Towns of LeRay and Rutland, County of Jefferson, State of New York, being the water properties owned by the Northern New York Utilities, Inc., known and described as the Lower Black River Power Plant, situated on the northerly side of the Black River in the said Town of LeRay, and the Upper Black River Power Plant, situated on the southerly side of the of the Black River in the said Village of Black River, including all water power, water rights, privileges, easements, dams raceways, canals, buildings, and fixtures of every kind appurtenant thereto.

CHANGES: SINCE DECEMBER 15, 1922

1938 Changed to Central New York Power Corporation

1951 Changed to Niagara Mohawk Power Corporation

2000 Changed to Erie Boulevard Hydropower, L.P.

Map

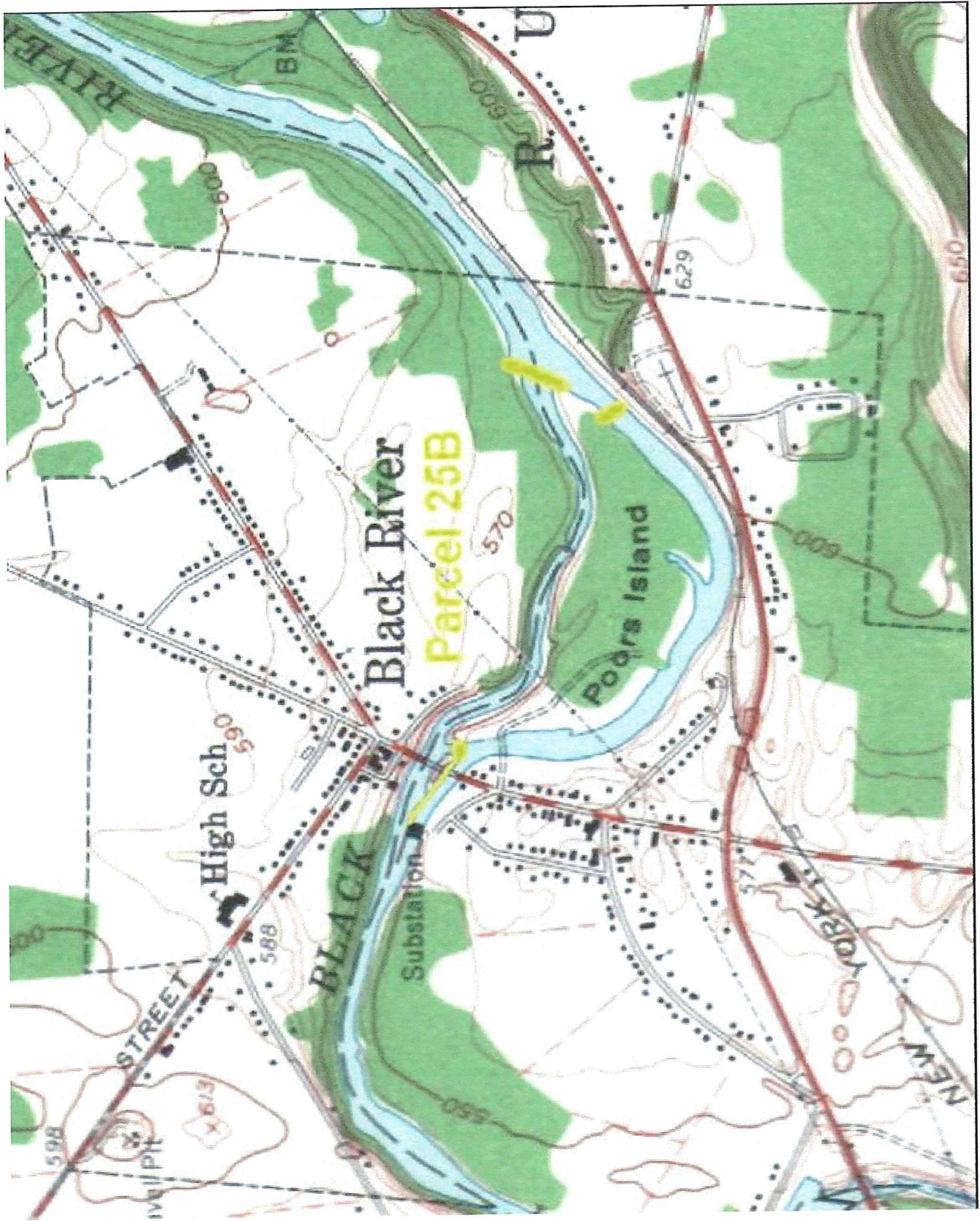

HUDSON RIVER-BLACK RIVER REGULATING DISTRICT

BENEFICIARY SITE SURVEY

HISTORY

Parcel No. 27 December 15, 1922 — Power Corporation of New York

All those certain tracts or parcels of real estate situated in the Villages of Deferiet and Herrings and in the Towns of Wilna and Champion, County of Jefferson, State of New York, being the water properties owned by the Power Corporation Of New York; said real estate is more particularly described as follows: (1) the water power and power plant situated on the northerly side of the Black River in the said Village of Deferiet, including dams and other structures across the Black River; (2) the water power and power plant situated on the northerly side of the Black River in the said Village of Herring, including dams and other structures across the Black River; and including also all water power, water rights, privileges, easements, dams raceways, canals, buildings and fixtures of every kind appurtenant thereto.

CHANGES: SINCE DECEMBER 15, 1922

1938 Changed to Northern Development Corporation

1951 Changed to Niagara Mohawk Power Corporation

2000 Changed to Erie Boulevard Hydropower, L.P.

HUDSON RIVER-BLACK RIVER REGULATING DISTRICT

BENEFICIARY SITE SURVEY

HISTORY

Parcel No. 28 December 15, 1922 — National Paper Products Company

All that certain tract or parcel of real estate situated in the Village of Carthage, County of Jefferson, State of New York, being that part of the Carthage water power property owned by the National Paper Products Company and situated on the northerly or easterly side of the Black River and on Guyote Island or adjacent thereto, and including all water power, water rights, privileges, easements, dams, raceways, buildings and mills and fixtures of every kind appurtenant thereto.

CHANGES: SINCE DECEMBER 15, 1922

- 1958 Changed to Crown Zellerbach Corporation
- 1988 Changed to James River Corporation
- 1999 Changed to Fort James Corporation
- 2000 Carthage Industrial Development Corporation

HUDSON RIVER-BLACK RIVER REGULATING DISTRICT

BENEFICIARY SITE SURVEY

HISTORY

Parcel No. 33 December 15, 1922 --- West End Paper Company

All that certain tract or parcel of real estate situated in the Villages of Carthage, and West Carthage, County of Jefferson, State of New York, being that part of the Carthage water power property owned by the West End Paper Company, situated on the northerly side of the Black River and on certain islands and in the bed of the said Black River, and including all water power water rights, privileges, easements, dams, flumes, raceways, buildings, mills and fixtures of every kind appurtenant thereto.

CHANGES: SINCE DECEMBER 15, 1922

- 1931 Changed to National Paper Products Company
- 1958 Changed to Crown Zellerbach Corporation
- 1988 Changed to James River corporation
- 1999 Changed to Fort James Corporation
- 2000 Carthage Industrial Development Corporation

Map

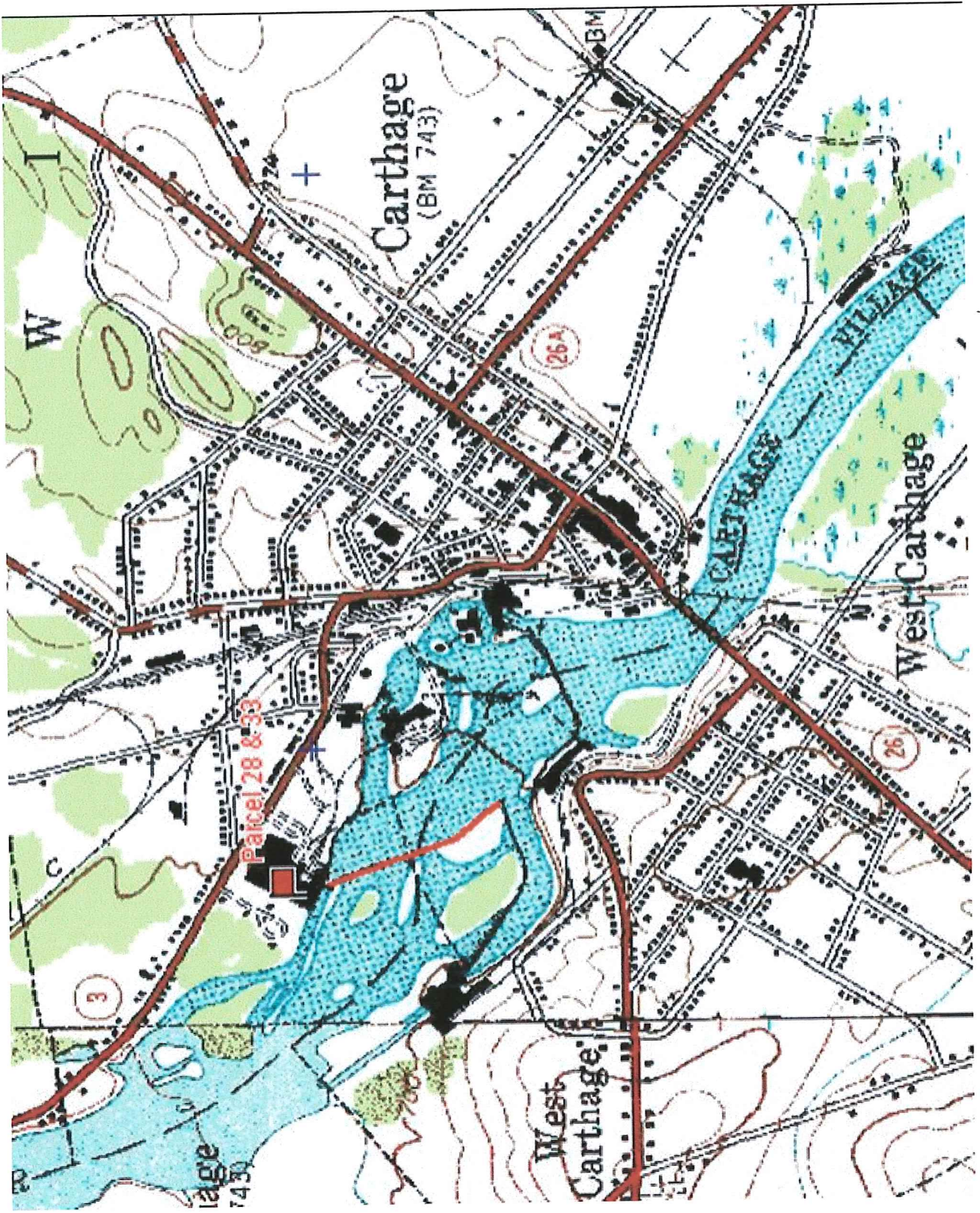

HUDSON RIVER-BLACK RIVER REGULATING DISTRICT

BENEFICIARY SITE SURVEY

HISTORY

Parcel No. 31 December 15, 1922 --- Island Paper Company

All that certain tract or parcel of real estate situated in the Villages of Carthage, and West Carthage, County of Jefferson, State of New York, being that part of the Carthage water power property owned by the Island Paper Company, situated on the northerly or easterly side of the Black River and on Tannery Island or other islands and in the bed of the said Black River, and including all water power, water rights, privileges, easements, dams, raceways, buildings, mills and fixtures of every kind appurtenant thereto.

CHANGES: SINCE DECEMBER 15, 1922

1966 Changed to Charles Ruderman

1988 Changed to Tannery Island Power Corporation

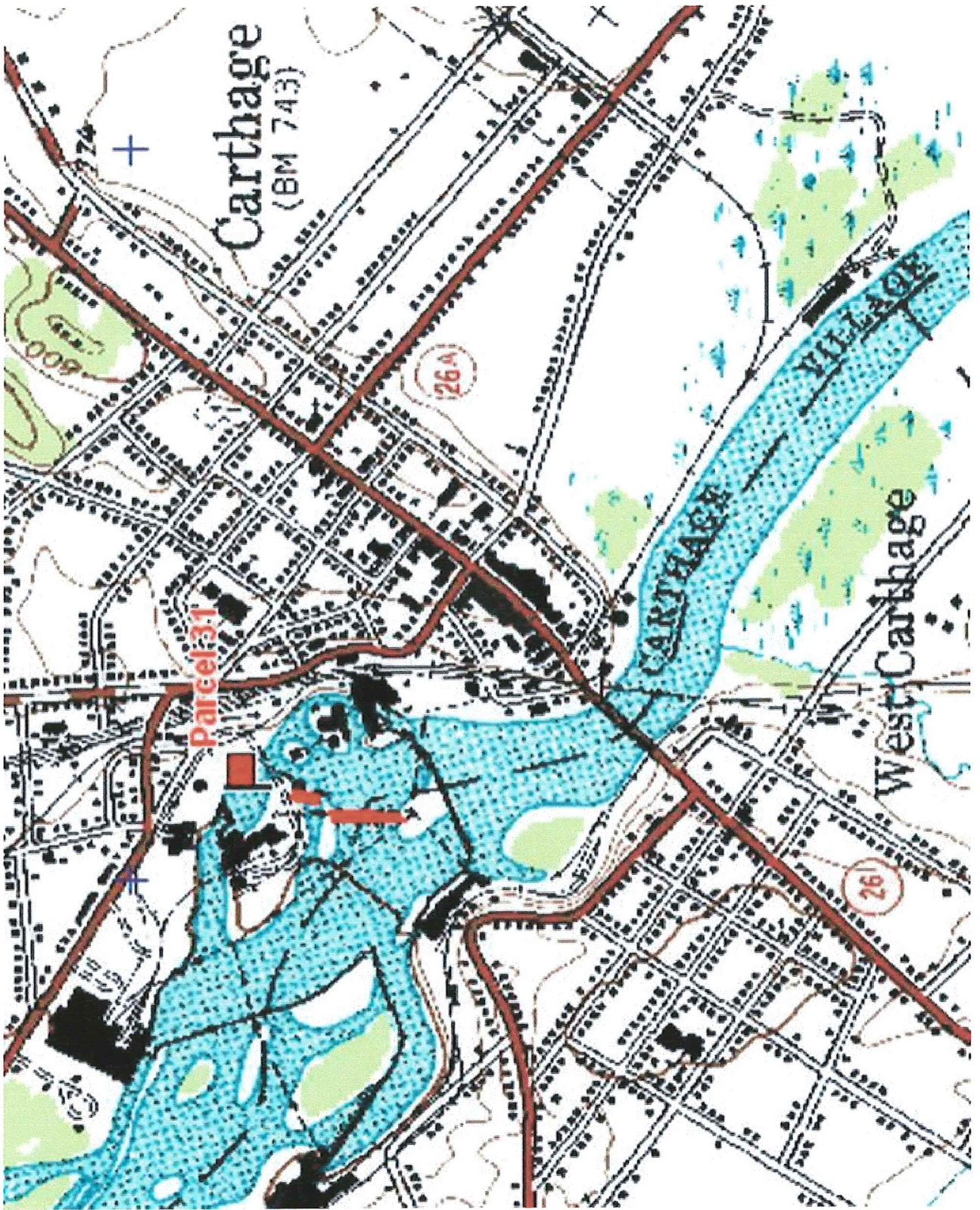

HUDSON RIVER-BLACK RIVER REGULATING DISTRICT

BENEFICIARY SITE SURVEY

HISTORY

Parcel No. 32 December 15, 1922 — Carthage Machine Company

All that certain tract or parcel of real estate situated in the Village of Carthage, County of Jefferson, State of New York, being that part of the Carthage water power property owned by the Carthage Machine Company situated on the northerly side of the Black River or on Tannery Island, or on other islands adjacent thereto, and including all water power, water rights, privileges, easements, dams, flumes, raceways, buildings, mills and fixtures of every kind appurtenant thereto.

CHANGES: SINCE DECEMBER 15, 1922

1988 Changed to Tannery Island Power Corporation

Map

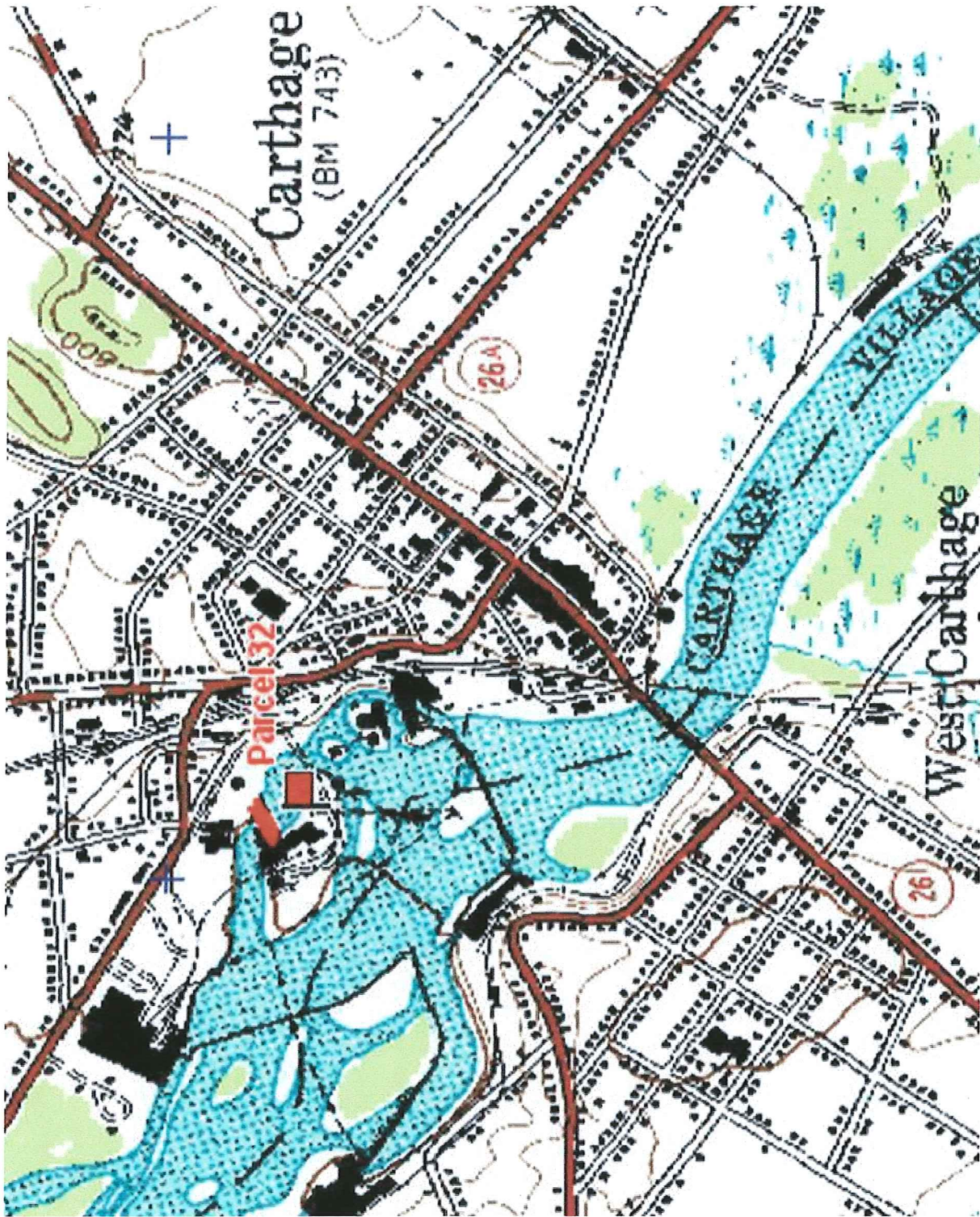

HUDSON RIVER-BLACK RIVER REGULATING DISTRICT

BENEFICIARY SITE SURVEY

HISTORY

Parcel No. 34 December 15, 1922 --- Champion Paper Company

All that certain tract or parcel of real estate situated in the Villages of Carthage, and West Carthage, County of Jefferson, State of New York, being that part of the Carthage water power property owned by the Champion Paper Company, situated on the southerly or westerly side of the Black River on certain islands adjacent thereto, including all water power, water rights, privileges, easements, dams, flumes, raceways, buildings, mills and fixtures of every kind appurtenant thereto.

CHANGES: SINCE DECEMBER 15, 1922

- 1948 Changed to Taggart Corporation
- 1959 Changed to St. Regis Paper Company
- 1970 Changed to Village of West Carthage
- 1984 Changed to Joseph Bossout
- 1991 Changed to Fourth Branch Associates

Map

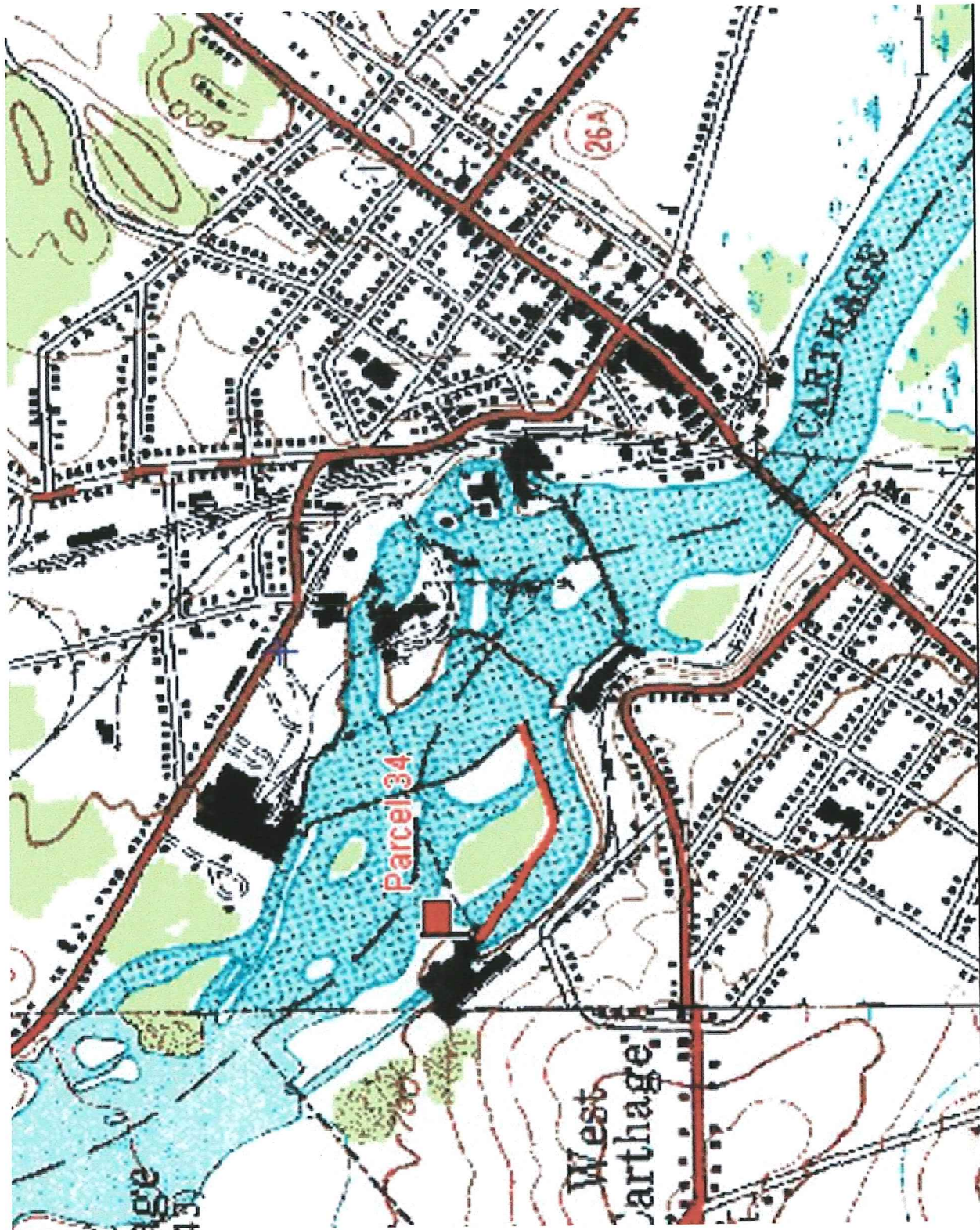

HUDSON RIVER-BLACK RIVER REGULATING DISTRICT

BENEFICIARY SITE SURVEY

HISTORY

Parcel No. 35 December 15, 1922 — Carthage Sulphite Pulp and Paper Company
All that certain tract or parcel of real estate situated in the Village of West Carthage, County of Jefferson, State of New York, being that part of the Carthage water power property owned by the Carthage Sulphite Pulp & Paper Company, situated on the southerly or westerly side of the Black River on certain islands adjacent thereto, including all water power, water rights, privileges, easements, dams, flumes, raceways, buildings, mills and fixtures of every kind appurtenant thereto.

CHANGES: SINCE DECEMBER 15, 1922

1926-27 Changed to Carthage Paper Board Company, Inc.

1935 Changed to Carthage Papermakers, Inc.

Map

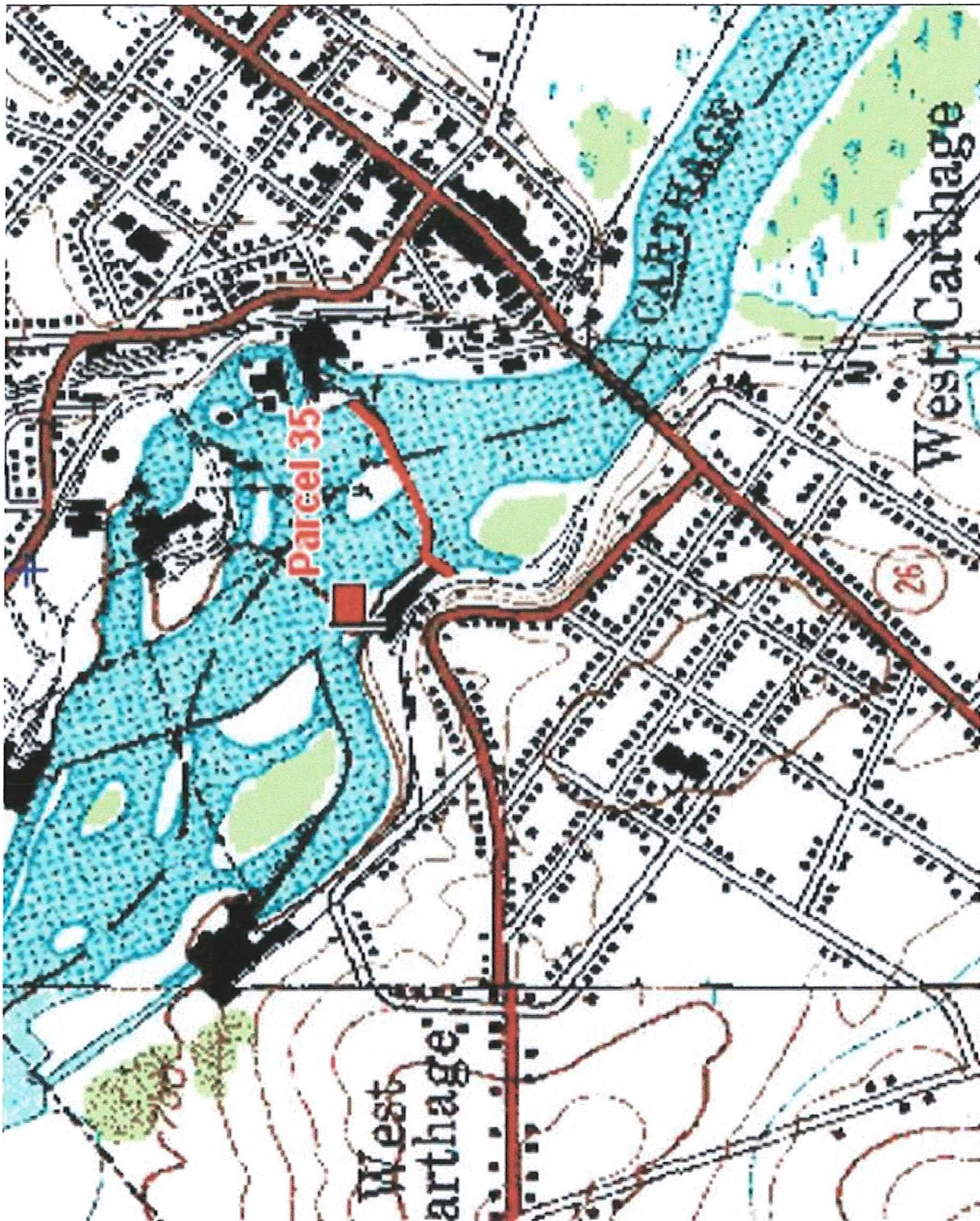

HUDSON RIVER-BLACK RIVER REGULATING DISTRICT

BENEFICIARY SITE SURVEY

HISTORY

Parcel No. 36 December 15, 1922 --- J. P. Lewis Company

All those certain tracts or parcels of real estate situated in the Towns of Croghan and New Bremen, County of Lewis, State of New York, being the water power and mill property owned by the J. P. Lewis Company at Beaver Falls; said real estate is more particularly described as follows: (1) the lower dam and mill property situated on the northerly side of the Beaver River, in the said Town of New Croghan, including the dam and other structures across the Beaver River; (2) the middle dam and mill property situated on the southerly side of the Beaver River, in the said Town of New Bremen, including the dam and other structures across the Beaver River; and including also all water power, water rights, privileges, easements, dams, raceways, flumes, buildings, mills and fixtures of every kind appurtenant to the said real estate above described.

CHANGES: SINCE DECEMBER 15, 1922

- 1974 Changed to Latex Fiber Ind. Inc.
- 1978 Changed to Boise Cascade Spec. Paper Board Div.
- 1992 Parcel 36 split to become two Parcels 36
36 Boise Cascade Spec. Paper Board Div.
36 Beaver Falls Power Company
- 1993 Parcel #36 becomes 36A and 36B
36A Specialty Paperboard Inc.
36B Beaver Falls Power Company
- 1999 Changed Parcel 36A to Fibermart Inc.
- 2000 Changed Parcel 36A to Armstrong Industrial Specialties Inc.
- 2001 Changed to Interface Solutions Inc.

HUDSON RIVER-BLACK RIVER REGULATING DISTRICT

BLACK RIVER AREA BENEFICIARY SITE SURVEY

SURVEY QUESTIONS

DATE OF SITE SURVEY: 6/27/00
DATE LAST UPDATED: 7/12/00

SITE NUMBER: 36B FERC #: P - 2823 - NY NATDAM #: NY00756
OWNER: Beaver Falls Power Company
MAILING ADDRESS: 4387 Annapolis Way
Marcellus, NY 13108
CONTACT PERSON: Rodney Coffey
PHONE NUMBERS: Work: (315) 474 - 7104
Fax: (315) 474 - 7123
E-MAIL ADDRESS: rcoffey@twcny.rr.com
SECONDARY CONTACT: Todd Nash - Plant Operator
PHONE NUMBERS: Work: (315) 493 - 2517 Pager: (315) 785 - 2141
Fax: (315) 493 - 0686
E-MAIL ADDRESS: todnash@aol.com
TAX MAP PARCEL #: 129.17 - 01 - 05.100

DESCRIPTION OF FACILITY:

This plant known as "Station 2" is situated directly below the hydro facility "Station 1" along the Beaver River. This site uses the natural bed rock for the majority of its dam structure. The Dam can be considered either as one unit or separated into three different dams parts. A main significance to this dam is a concrete block situated in the middle of the northern most dams. This structure used to allow logs to flow by when they used to float logs down the river. The storage area for this hydro facility is 4 acres. Two turbine units 500 kW apiece harnesses the rivers energy. These two units can handle 360 c.f.s. per unit. This facility usually only gets enough water flow to sustain one unit full time. The second unit may run at 50% when the river has a high flow rate.

LATITUDE: N43 - 53' - 2.7"

LONGITUDE: W75 - 25' - 49.7"

COMPASS BEARING OF DAM AXIS:

North: 344 deg. M
Middle: 352.5 deg. M
South: 240 deg. M

ELEVATION OF CREST: 769.3'

HISTORY OF DAM:

1. Year Constructed: 1979
2. Type of Dam: Concrete Gravity
3. General Condition: Good

Map

